

S12-230AGM 12V, 230Ah AGM VRLA Deep Cycle Battery by Rolls



Price: CAD \$869.00

SKU: SB-S12-230AGM

Product Categories: [Batteries](#), [Lead-Acid](#), [Sealed : AGM/GEL \(VRLA\)](#), [Shop](#)

Product Tags: [12 Volt](#), [12 volt agm](#), [12v](#), [230](#), [230Ahr](#), [agm battery](#), [maintenance-free](#), [Rolls](#), [s12-230agm](#), [s12-230agm canada](#), [sealed](#), [sla](#), [Surrette](#)

Product Page:

<https://www.modernoutpost.com/product/s12-230agm-12v-230ah-agm-vrla-deep-cycle-battery-by-rolls/>

Product Summary

S12-230AGM 12V, 230Ah AGM VRLA Deep Cycle Battery by Rolls (Surrette Battery of Canada). Rolls by Surrette's sealed AGM batteries feature a high cycle life without the need for maintenance.

Product Description

S12-230AGM 12V, 230Ah AGM VRLA Deep Cycle Battery by Rolls (Surrette Battery of Canada). Rolls by Surrette's sealed AGM batteries feature a high cycle life

without the need for maintenance.

AGM technology (Absorbed Glass Mat) keeps the electrolyte contained in a glass-fibre material, which enables ion flows and eliminates gassing while charging. AGM batteries are non-hazardous, resulting in lower shipping costs and they can also be shipped via air. AGM batteries have a very low self-discharge rate, and can handle higher charge currents vs. regular flooded lead-acid batteries. Sealed AGM batteries can be placed anywhere without having to worry about fumes. They are also somewhat more suitable for cold places as they are more frost-proof than regular flooded lead-acid batteries.

The Rolls AGM line of batteries are designed for a variety of maintenance free applications and come with a 7 year warranty (changing to 3-years starting January 2019).

Rolls S12-230AGM Specifications

Battery Voltage : 12 Volt

Amp-hour Capacity (20-hour) : 210 Ah

Dimensions (WxDxH) : 53.0 x 20.9 x 23.9cm

Weight : 60.5 kg (133 lbs)

Surette Battery Resources...

[Rolls / Surrette Web site](#)] [Rolls / Surrette AGM batteries overview \(pdf\)](#)] [Rolls / Surrette battery brochure \(pdf\)](#)] [Rolls / Surrette S12-230AGM spec sheet \(pdf\)](#)] [Rolls / Surrette battery care manual \(pdf\)](#)] [Depth-of-Discharge vs. Voltage for Surrette batteries \(pdf\)](#)] [Rolls / Surrette warranty document \(pdf\)](#)]

Product Attributes

- Dimensions: 55 × 22 × 24 cm
- Weight: 61 kg

Product Gallery

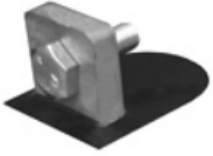

LT - Lug Terminal